

# Bronze Valve Options and Accessories - Handles

**Matrix of Bronze Valve Handwheel Diameters**

Valve	T062142 PP 2½" Dia.	T062459 PP 2½" Dia.	T062143 PP 3¼" Dia.	T065573 PP 3¼" Dia.	T062144 PP 4½" Dia.	T065574 PP 4½" Dia.	T062145 PP 5⅝" Dia.	T065575 PP 5⅝" Dia.	T062146 PP 7" Dia.	Valve
111	1/4 - 3/8	1/2 - 3/4	1	1¼ - 1½		2 - 2½		3		GATE
113	1/4 - 3/8	1/2 - 3/4	1	1¼ - 1½		2 - 2½		3		
124	1/4 - 3/8	1/2	3/4 - 1	1¼	1½	2	2½	3		
131	1/4 - 3/8	1/2	3/4 - 1	1¼	1½	2	2½	3		
133	1/4 - 3/8	1/2	3/4 - 1	1¼	1½	2	2½	3		
134	1/4 - 3/8	1/2	3/4 - 1	1¼	1½	2	2½	3		
136	1/4 - 3/8	1/2	3/4 - 1	1¼	1½	2	2½	3		
154A	1/4 - 3/8	1/2	3/4 - 1	1¼	1½	2				
174A	1/4 - 3/8	1/2	3/4 - 1	1¼	1½	2				
174SS		1/2	3/4 - 1	1¼	1½	2				
176A	1/4 - 3/8	1/2	3/4 - 1	1¼	1½	2				
176SS		1/2	3/4 - 1	1¼	1½	2				
211	1/8 - 1/2	3/4	1 - 1¼		1½	2		2½ - 3		
235	1/8 - 3/8	1/2	3/4	1	1¼	1½ - 2	2	2½	3	
256AP		1/4 - 1/2		3/4	1	1¼ - 1½	2	2½	3	
275B		1/8 - 3/8	1/2	3/4 - 1	1	1¼ - 1½	2	2½	3	
275Y		1/4 - 3/8	1/2	3/4 - 1		1¼ - 1½	2	2½	3	
276AP		1/4 - 3/8	1/2	3/4	1	1¼ - 1½	2	2½	3	
311	1/4 - 1/2	3/4	1 - 1¼			2		2½ - 3		
335	1/8 - 3/8	1/2	3/4	1	1¼	1½ - 2			3	
375B		1/4 - 3/8	1/2	3/4	1	1¼ - 1½	2		3	
376AP		1/4 - 3/8	1/2	3/4	1	1¼ - 1½	2			

**Malleable Iron ASTM A47**

Available as standard for NIBCO® Bronze Gate and Globe Valves. Class 125, 150, 200, 300 lb. SWP Bronze Body Valves. ¼" thru Square Stem only.

**Malleable**



**Red Bronze 85-5-5-5% ASTM B62**

Available for some NIBCO® 125 lb. SWP Bronze Body Valves ¾" thru 3". Used where standard handwheel would be out of reach or hand space is restricted. Specify by adding (K) to Fig. No., i.e. T-000-K. For field replacement, specify valve type and size. Square Stem Only.

**Cross**



**Red Bronze 85-5-5-5% ASTM B62**

Available for some NIBCO® 125 lb. SWP Bronze Body Valves ¾" thru 2". Used where code requirements or personal preference dictate a bronze handwheel. Specify by adding (BHW) to Fig. No., i.e. T-000-BHW. For field replacement, specify valve type and size. Square Stem Only.

**Bronze**

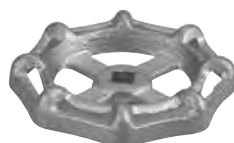

**Red Bronze 85-5-5-5% ASTM B62**

Available for some NIBCO® 125 lb. SWP Bronze Body Valves. Used where standard handwheel would be out of reach or hand space is restricted. Square Stem only.

**Solid Tee**



**Red Bronze 85-5-5-5% ASTM B62 or ASTM B16**

Available for some NIBCO® 125 lb. SWP Bronze Body Valves thru 3". Use where valve might be subject to unauthorized use or tampering. Specify by adding (L) to Fig. No., i.e. T-000-L. For field replacement, specify valve type and size. Square Stem Only.

**Lockshield**



**Red Bronze 85-5-5-5% ASTM B62**

Available for some NIBCO® 125 lb. SWP Bronze Body Valves thru 3". Used as handle for lockshields. Specify – "Lockshield Key." For field replacement, specify valve type and size. Square Stem Only.

**Lockshield Key**



NIBCO INC. reserves the right to change materials, options and accessories without notice.